

Proposal 01 Certificate of Lawfulness sought for the conversion of an 'Agricultural Barn' building to Dwelling / Holiday Let.

All heights, sizes and dimensions should be checked on site by the contractor before any work is put in hand.

Figured dimensions should be taken in preference to scaling and any errors or omissions reported to the architect at once.

This drawing has been prepared in accordance with the CDM (Construction Design and Management) and all foreseeable design risks to those involved or affected by construction have been avoided wherever possible.

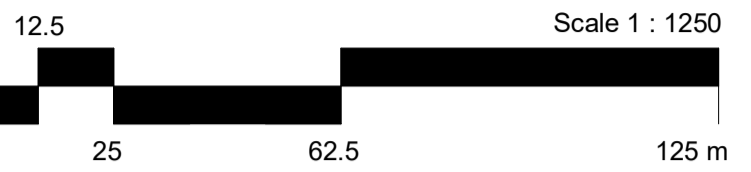

Knypersley Mill Listing Description
 List Entry Number: 1374604
 Heritage Category: Listing
 Grade: II
 Location: Knypersley Mill, Judgefield Lane, Brown Edge, KNYPERSLEY, Staffordshire Moorlands, Staffordshire
 SJ 85 SE 3/23
 BROWN EDGE C.P. Knypersley JUDGEFIELD LANE. Knypersley Mill
 II Mill, now converted to a dwelling. Dated 1827. Red sandstone ashlar; raised strings at upper floor, cill levels; rusticated dressings; tied roof; verge parapets on corbelled kneelers. Lower front of three storeys (mill pond side single storey) and four windows; C20 casements in segmental-headed openings, paired to left (inset to centre on ground floor) and widely-spaced to right, the top floor windows have had their cills lowered; two entrances under right-hand windows, segmental-headed and with boarded doors; a plaque over left-hand door is inscribed "ERECTED/1827". All working gear removed from interior
 Listing NGR: SJ8958654765

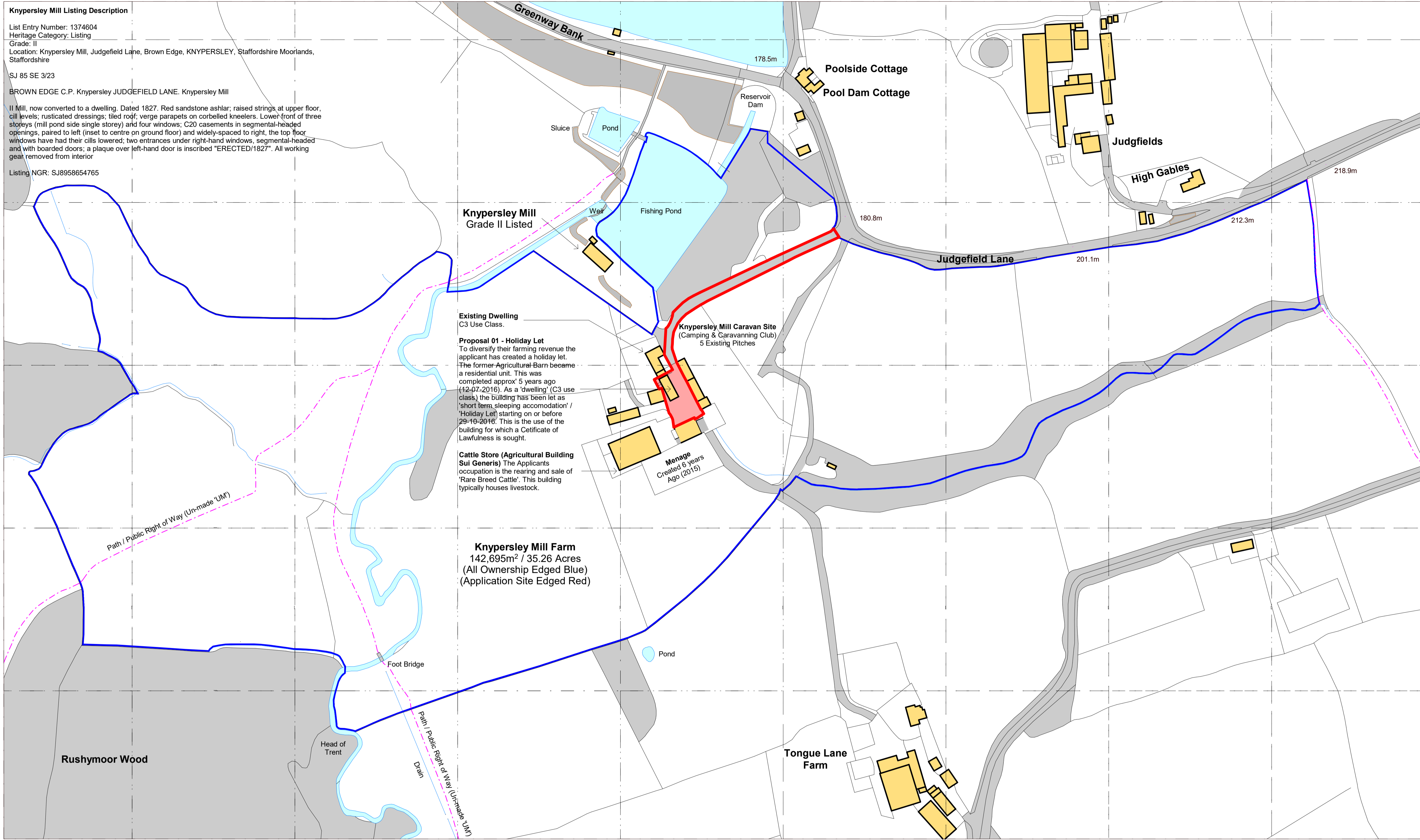

Knypersley Mill
 Grade II Listed

Existing Dwelling
 C3 Use Class.

Proposal 01 - Holiday Let
 To diversify their farming revenue the applicant has created a holiday let. The former Agricultural Barn became a residential unit. This was completed approx 5 years ago (12-07-2016). As a 'dwelling' (C3 use class) the building has been let as 'short term sleeping accommodation' / 'Holiday Let' starting on or before 29-10-2016. This is the use of the building for which a Certificate of Lawfulness is sought.

Cattle Store (Agricultural Building Sui Generis) The Applicants occupation is the rearing and sale of 'Rare Breed Cattle'. This building typically houses livestock.

Knypersley Mill Farm
 142,695m² / 35.26 Acres
 (All Ownership Edged Blue)
 (Application Site Edged Red)

Knypersley Mill Caravan Site
 (Camping & Caravanning Club)
 5 Existing Pitches

Menage
 Created 6 years Ago (2015)

Poolside Cottage
Pool Dam Cottage

Judgfields

High Gables

Tongue Lane Farm

Rushmoor Wood

Head of Trent

Foot Bridge

Drain
 Path / Public Right of Way (Un-made 'UM')

Ordnance Survey, (c) Crown Copyright 2021. All rights reserved. Licence number 100022432

Location Plan
 SCALE 1 : 1250

P0.2	14-06-21	BJ	Watermarks removed to validation requests
P0.1	04-05-21	BJ	Revision requested by TM during 'Checking Process'

Rev Date By Detail

Drawing status

S3 : Planning

Client

Mr M. Hall

Project/Location

Land associated with Knypersley Mill Farm, Judgefield Lane, Brown Edge, Staffordshire, ST6 8UG

Grid Ref: SJ 89625 54705
 Easting (X):389625 , Northing (Y) :354705

Drawing title

01 Certificate of Lawfulness - Location Plan

Date	Drawn	Checked	Job No.
31-03-21	BJ	TM	3204

Scale(s)

1 : 1250 @A1

Drawing number **Revision**

KMFH-SA-01-XX-DR-A-0101 P0.2



12 High Street, Tean,
 Stoke-on-Trent
 ST10 4DZ
 T: +44 (0)1538 722097
 E: mail@smytheman.co.uk
 W: www.smytheman.co.uk

